

Quick Start — Oriented Specimens

1. Transfer screen from capsule to workstation.

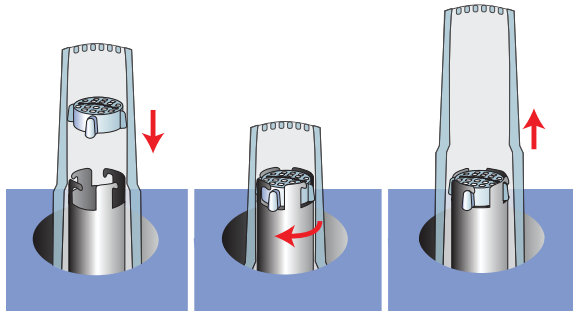

Twist capsule to lock screen

2. Load and orient specimen.

A. Compression method

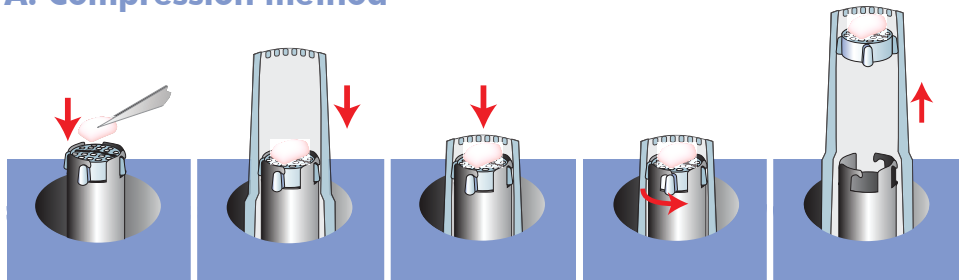

Orient on the closed screen

Gently compress specimen

Twist capsule to release screen

Remove loaded capsule

B. Pinch method

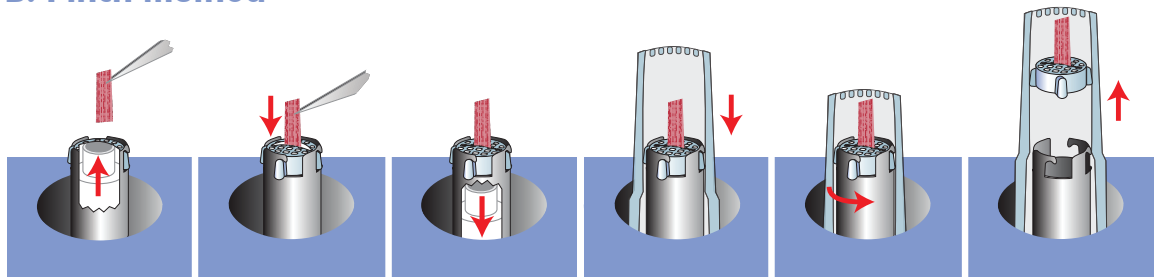

Push lever to open slot in screen

Insert specimen into slot

Release lever to close slot

Twist capsule to release screen

Remove loaded capsule

3. Label capsule and process specimen.

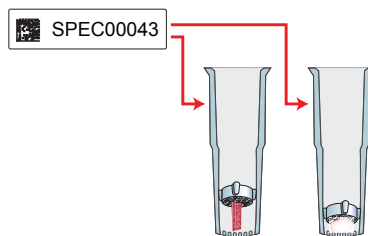

Apply label

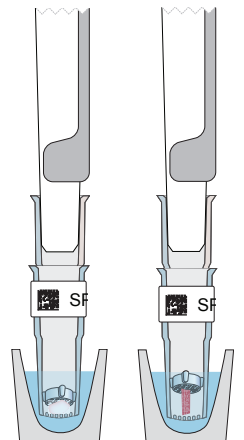

Attach pipettor and process

